

Ground floor
Existing washroom layout

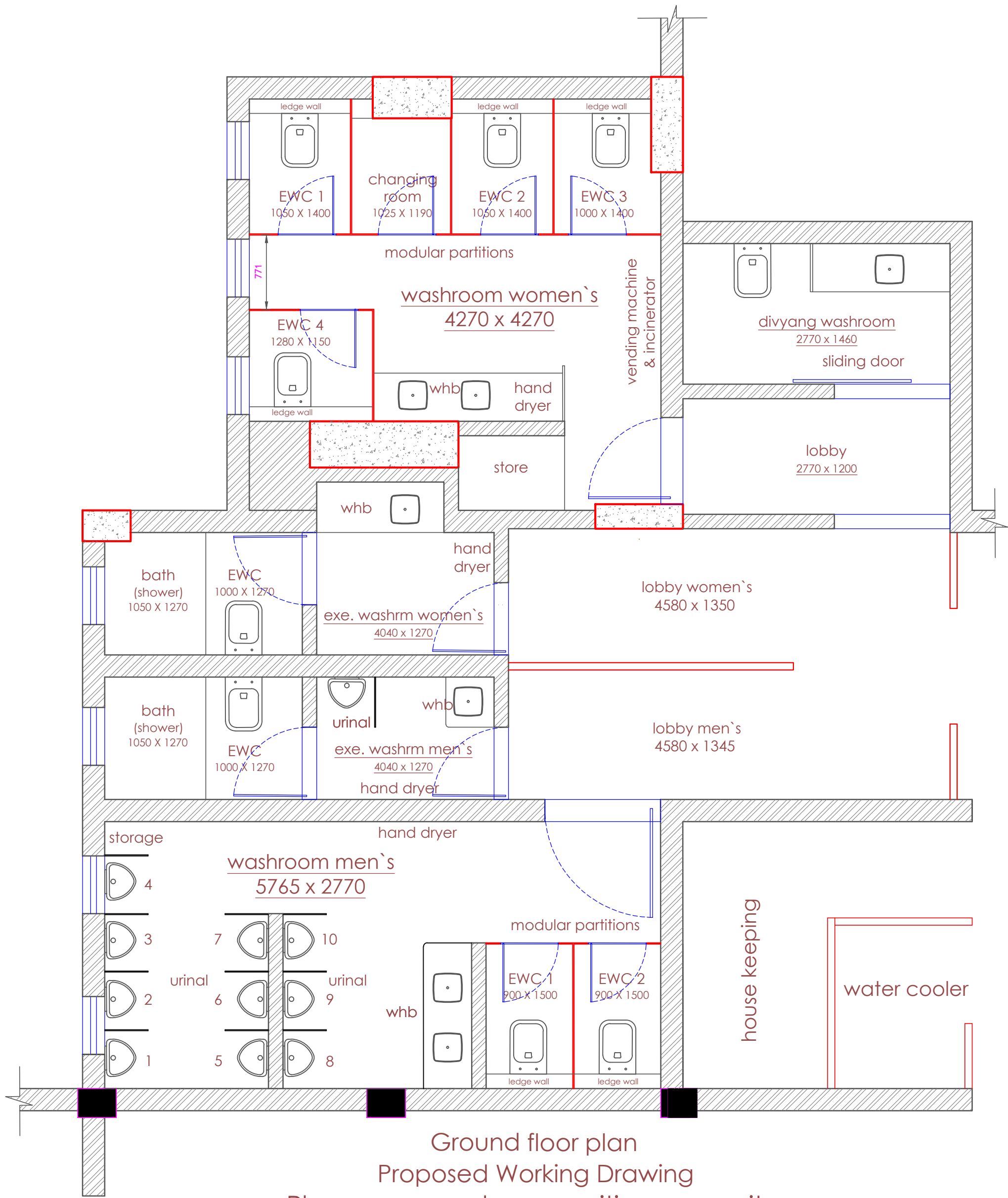

Ground floor plan
Proposed Working Drawing
Plans as per column position as on site

| | | | | | | |
|----------------|--|---------|-----------|--------|---|--|
| COMP DETAIL | PROJECT: PROPOSED WASHROOM RENOVATION AT WELINGKAR INSTITUTE OF MANAGEMENT DEVELOPMENT & RESEARCH AT L.N.ROAD, MATUNGA(EAST), MUMBAI - 400 019. | | | | DESIGNED BY | |
| | FOR: SHIKSHAN PRASARAK MANDALI, PUNE. | | | | KAILASH SONTAKKE REGD ARCHITECT CA 84-8700 | |
| | DRAWING: WASHROOM - WORKING DRAWING | | | | TEL:020 2553 5436. EMAIL: kaison.144@gmail.com / kailash@assoarch.com | |
| | SCALE | | | | THIS DRG & THE CONNECTED DESIGN IS OUR SOLE PROPERTY & COPYRIGHT IT IS LOANED ON CONDITION OF RETURN ON DEMAND IT SHALL NOT BE COPIED LENT OR USED WITHOUT OUR PRIOR WRITTEN CONSENT | |
| | | JOB NO. | DRG. NO. | DATE | DRAWN BY. | ASSOCIATED ARCHITECTS SINCE 1983 |
| | | | 130625-01 | 130625 | MRUNALI | |