

Fourth floor
Existing washroom layout

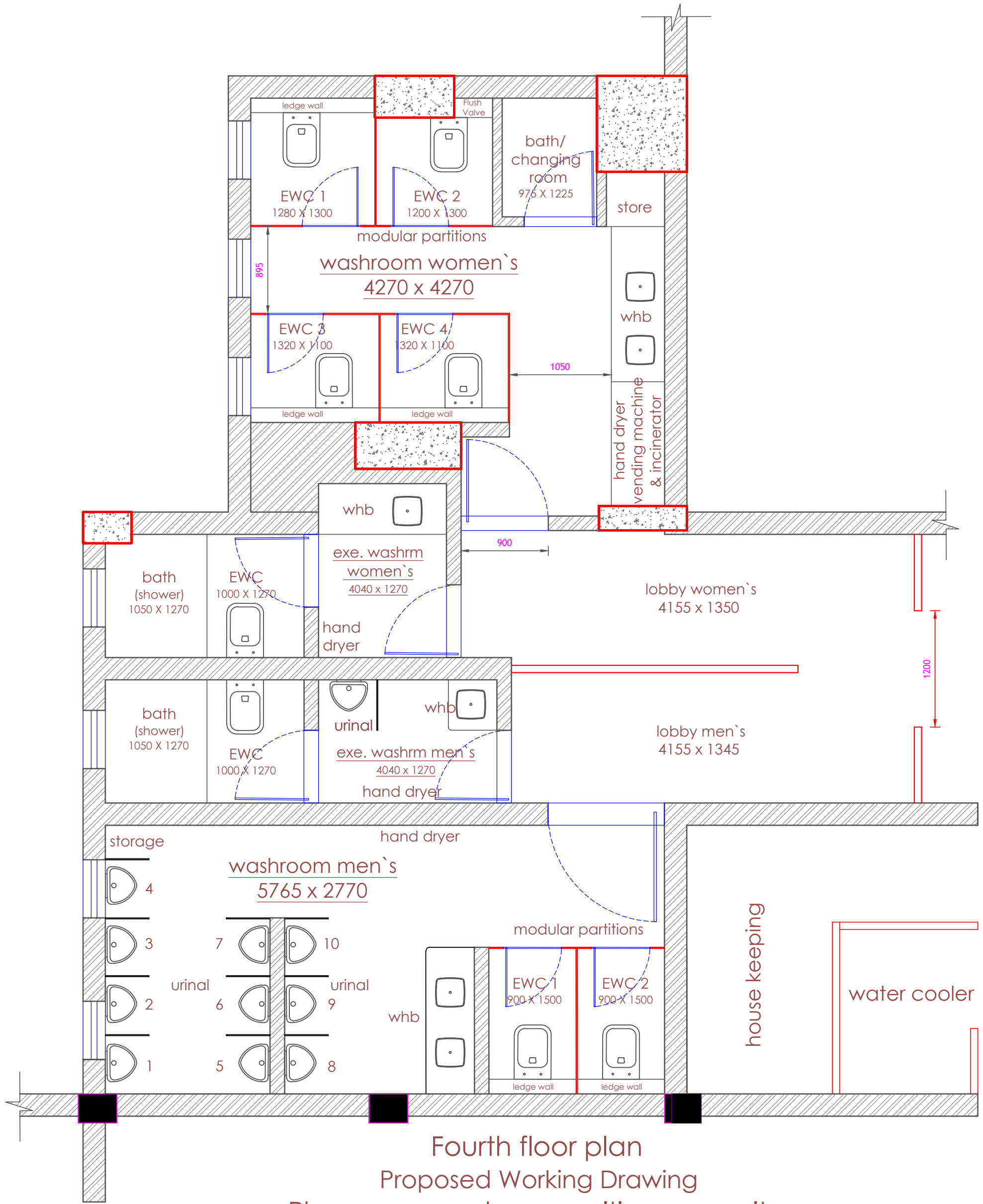

Fourth floor plan
Proposed Working Drawing
Plans as per column position as on site

COMP DETAIL	PROJECT: PROPOSED WASHROOM RENOVATION AT WELINGKAR INSTITUTE OF MANAGEMENT DEVELOPMENT & RESEARCH AT L.N.ROAD, MATUNGA(EAST), MUMBAI - 400 019.				DESIGNED BY	
	FOR: SHIKSHAN PRASARAK MANDALI, PUNE.				KAILASH SONTAKKE REGD ARCHITECT CA 84-8700	
	DRAWING: WASHROOM - WORKING DRAWING				TEL:020 2553 5436. EMAIL: kaison.144@gmail.com / kailash@assoarch.com	
	SCALE				THIS DRG & THE CONNECTED DESIGN IS OUR SOLE PROPERTY & COPYRIGHT IT IS LOANED ON CONDITION OF RETURN ON DEMAND IT SHALL NOT BE COPIED LENT OR USED WITHOUT OUR PRIOR WRITTEN CONSENT	
		JOB NO.	DRG. NO.	DATE	DRAWN BY.	ASSOCIATED ARCHITECTS SINCE 1983
			130625-05	130625	MRUNALI	